

SANDWICH PANEL INSTALLATION DETAILS



Page no:

1/3

1-1 DETAIL

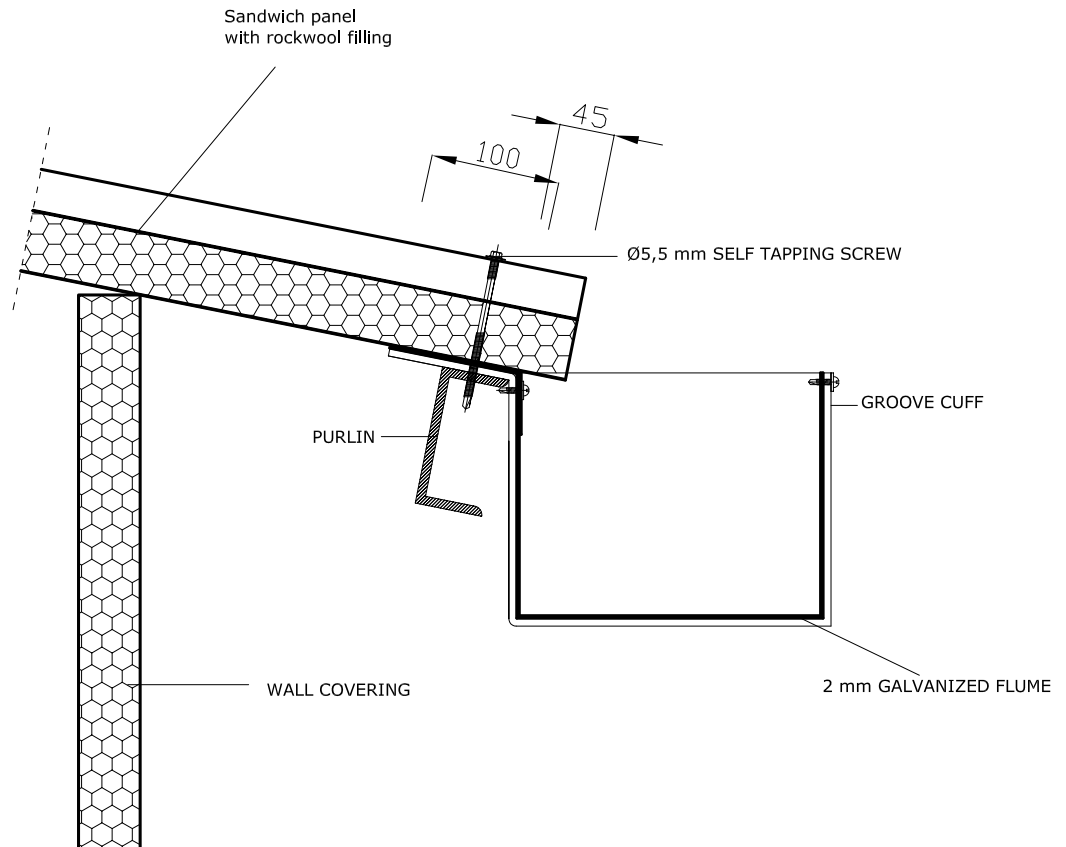

ALTERNATIVE 1: PANEL EDGE WITHOUT DROPPER

NOTE: SELF TAPPING SCREW WILL BE Ø5,5mm and 12mm DRILL POINT

* Details are intended for information and suggestion and may vary depending on project.