

SANDWICH PANEL INSTALLATION DETAILS

Sepa

Page no: 1/16

20-20 DETAIL

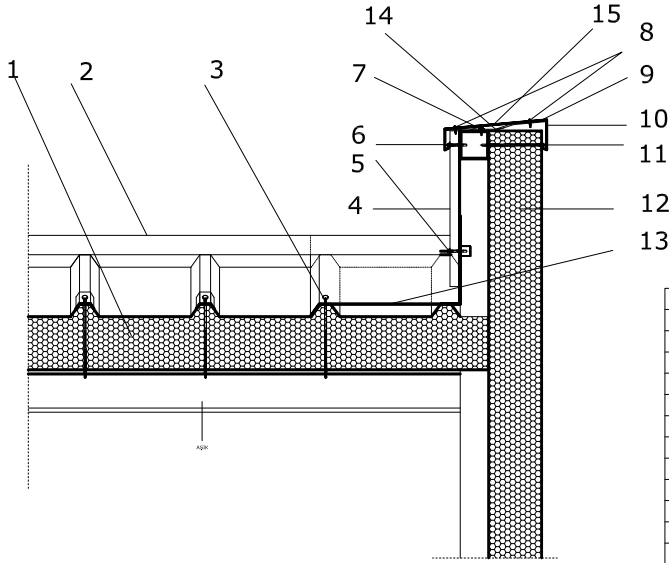

| NO | MATERIAL CODE | MATERIAL |
|----|---------------|---|
| 1 | | Rockwool sandwich panel |
| 2 | | Upper ridge |
| 3 | | Ø5.5x.....mm Self tapping screw |
| 4 | | 38/151 Coated corrugated sheet 0,5 mm thickness |
| 5 | | Ø5.5 x 60 mm Self tapping screw |
| 6 | | Ø5.5 x 60 mm Self tapping screw |
| 7 | | Upper ridge |
| 8 | | Ø5.5 x 40 mm Self tapping screw |
| 9 | | Parapet head Installation bar |
| 10 | | 0.7 mm Thick coated sheet heading cover |
| 11 | | Ø5.5x.....mm Self tapping screw |
| 12 | | Rockwool sandwich panel |
| 13 | | Edge strip |
| 14 | | Parapet head Installation bar |
| 15 | | Parapet sheet |

NO15 : PARAPET SHEET

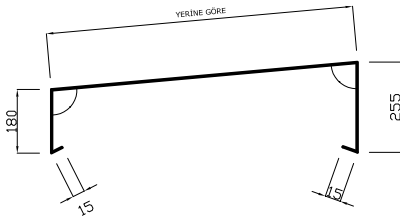

NO14 : PARAPET HEAD INSTALLATION BAR

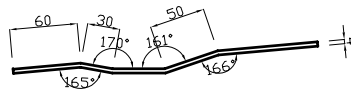

NOT: IT WILL BE PRODUCED FROM 40X4mm SHEET BAR
AND INSTALLED WITH INTERVALS OF 500mm

NO13 : EDGE STRIP

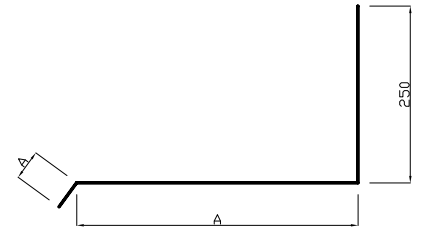

* Details are intended for information and suggestion and may vary depending on project.